

PERFECT COMBINATION BETWEEN  
TECHNOLOGY AND DESIGN

# The future shines bright.

## JScan 5 IS THE COMBINATION BETWEEN TECHNOLOGY AND DESIGN.

A new 3D scanner series that provides an open work station which can handle any object from the simplest to the most complex, including semi-reflective items.

JScan 5 is an easily operated high precision, two axes 3D scanner based on structured light technology, perfect in any context used.

The internal power supply reduces the space occupied by the scanner, making it compact and with a modern design.

## JScan 5 Features

THE DATA PRODUCED BY DScan 5 CAN BE EXPORTED IN THE MOST COMMON FORMATS TO BE READ BY ANY CAD/CAM SYSTEM.



### OPEN DESIGN

Thanks to the new open configuration, dimensions are no longer a problem. JScan 5 allows the scanning of any items.



### RELIABLE

JScan 5 and its acquisition software have been completely developed in-house allowing perfect compatibility and great reliability.



### QUICK AND INTUITIVE

Even the most complex multiple acquisitions can be easily performed, thanks to a fast and intuitive interface.



### PLUG & PLAY

Supplied with Leios 2 software, the proprietary software of EGS and an integrated PC, JScan 5 is completely Plug & Play. Only a monitor and a mouse are required to use the scanner.

# High level performance.

## **JScan 5 GUARANTEES MAXIMUM PRECISION AND ACCURACY.**

JScan 5 ensures high precision and accuracy up to 5 microns. It allows to acquire even the smallest details where complex shaped is required, enabling 3D reconstructions extremely conforming to the original.

JScan 5 presents high quality electronic and mechanical components for greater reliability, speed and efficiency and a completely open system that offers the possibility of importing and exporting data in standard formats (STL, PLY, OBJ, ASC) that can be used by any CAD / CAM software.

Thanks to the sensitive and high-precision cameras with USB 3.0 interface, capable of capturing at the speed of 25 fps, and to the other latest generation internal components, JScan 5 achieves 40% higher performance than the previous version.

The whole optical unit is tilted in order to avoid that the projected light could hit the operator's eyes.

# Complete scanning strategies.



## **DISCOVER THE CLEVER ACQUISITION: EXPERIENCE A SIMPLE AND INTUITIVE WORKFLOW**

Customize your scanning at the highest level.

Jscan 5 offers maximum versatility and the possibility to choose the scanning strategy that most suits your needs.





# Choose your color.

EGS OFFERS THE POSSIBILITY OF COMPLETE HARDWARE AND SOFTWARE CUSTOMIZATION  
TO MEET ANY SPECIFIC TECHNICAL REQUEST.



BLACK



WHITE

# With integrated PC and CAD software.









## le:OS 2

Leios 2 is a fast, reliable and easy-to-use solution for the 3D scanning processing, mesh editing and reverse engineering. Thanks to the redesigned interface and to the new workflow organization, users are able to manage the scanning process in an immediate and effective way.

With Leios 2 it is possible to process data coming from any other 3D scanner on the market, starting from the point cloud's manipulation to the construction of a NURBS mathematical model. The data processing occurs in a simple and intuitive way and it is characterized by the continuous control of every work phase and by the final analysis of the results through powerful inspection tools.

Leios exports the datasets in many formats, both polygonal and CAD, suitable for several fields like: industrial design, engineering, simulation, archaeology, medical and dental industry, animation and so on.

For 15 years EGS has been designing software solutions with a clear goal: providing users a simple and easy-to-use solution, but also reliable and powerful for the 3D scan calculations, reverse engineering and 3D design.

-  **STREAMLINED WORKFLOW**
-  **FASTER TIME-TO-MARKET APPROACH**
-  **SCANNER INTEGRATION AND CAD FRIENDLY OUTPUT**
-  **64BIT AND MULTICORE SUPPORT**
-  **SCULPTING TOOLS**
-  **LEIOS COMPONENTS: THE HEART OF IT ALL**

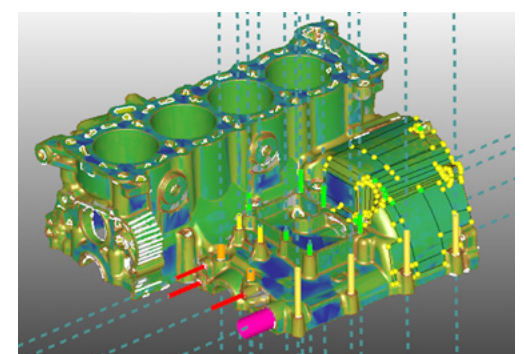
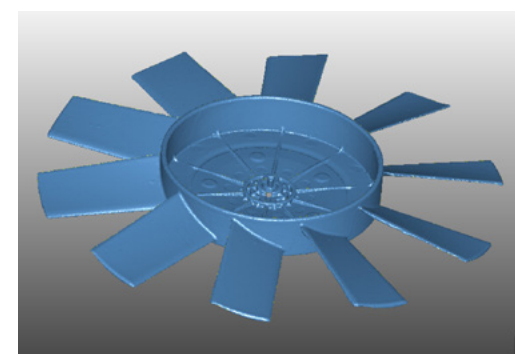
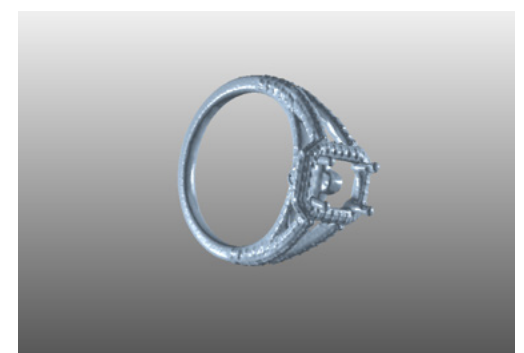
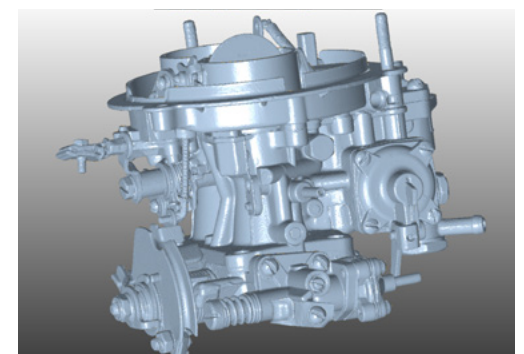

We're an environmentally friendly company and for our scanners we minimize the use of plastics.

# FEATURES

## TECHNICAL SPECIFICATIONS

3D SCANNING TECHNOLOGY	Structured Light
CAMERA RESOLUTION	1.3 megapixel USB 3.0
LIGHT SOURCE	LED, 100 ANSI-lumen, blue light
ROTARY PLAN	2-axis movement (rotation, inclination)
3D SCAN AREA (W x D x H)	90 x 80 x 55 mm
ACCURACY	0.005 mm
INPUT DATA FORMAT	STL, ASC, PLY, OBJ
OUTPUT DATA FORMAT	STL, ASC, PLY, OBJ
DIMENSION (W x D x H)	275 x 465 x 450 mm
WEIGHT	19 Kg
MAINS CONNECTION	100/240 Vac
AVAILABLE COLOURS	Bianco, Nero

## FEATURES

MAXIMUM RELIABILITY	High quality mechanical and electronic components.
COMPACT SIZE (INTEGRATED PC)	Thanks to its small size and weight, JScan 5 can be used in any workstation
CUSTOMIZED CONFIGURATION	The user is able to completely customize the scanning strategies and modeling options.
OPEN SYSTEM	Data can be exported in open formats, which can be read using any CAD / CAM system.
LIFETIME LICENSE	The software license is permanent without mandatory annual costs.
UPDATE AND SUPPORT	Software maintenance is not mandatory but is available upon request.

## INTEGRATED PC CHARACTERISTICS

CPU Intel i7 10700F 4.8 Ghz	MEMORY 32 GB RAM
GPU NVIDIA GeForce GT 1030 2GB GDDR5	INPUT/OUTPUT 2 HDMI, 1 DVI-D, 2 USB 3.0, 2 USB 2.0 Eth 10/100/1000 Mbps
HARD DISK SSD 1 TB SATA	S.O. Windows 10 Pro License 64 bit



EGS SRL  
VIA DEL TAPPEZZIERE, 4  
40138 BOLOGNA | ITALY  
  
T. +39 051 19 93 01 01  
egs-info@egsolutions.com  
[www.egsolutions.com](http://www.egsolutions.com)

### FOLLOW US

- f EGSolutions
- t EGS3Dinnovation
- i e.g.s.-srl
- C egsolutions\_
- y EGS srl

SHARE WITH US  
USING  
**#ShineWithJScan5**

100%  
MADE IN ITALY  
WITH A GLOBAL  
VISION.

Located in Bologna, Italy, EGS constantly invest in research & development to consolidate its worldwide recognition in 3D technology and solutions – 3D scanners, CAD design and integration with CAM modules.

From May 2020 EGS is part of Yndetech srl group, a company operating in the digital domain and producing manufactured products for the dental sector. EGS works alongside Yndetech to provide high quality solutions to customers around the world through innovation while offering products, solutions and services manufactured in-house and in Italy.